

GUMLEAVES

Bush Holidays



Gumleaves is set amid 400 acres of natural bushland. It is centrally located on the sunny East Coast just 120km north east of Hobart and 175km south east of Launceston. We offer a wide range of activities that are ideal for the whole family or group.

Get away for a weekend and relax on the balcony, or go for a bush walk. Let the kids run wild on the adventure playgrounds, or enjoy a some tennis.



You can also visit some of our nearby attractions, from a day trip to Freycinet or Maria Island National Parks, or a trip to the beach. Perhaps take a trip to picturesque Swansea, or visit the fishing town of Triabunna.

On Site Activities

EXTREME Obstacle Course



Physically challenge yourself and your mates on our EXTREME obstacle course! Put your strength and fitness to the ultimate test on the cargo nets, giant monkey bars, swinging tyres, ropes and wires - plus logs to climb along, under, up and over!

Challenge Courses

Various challenge activities have been created for you and your group to tackle. They are spread out so you can have some privacy and feel comfortable to make fools of yourselves! Rules of each challenge are located at the actual challenge site. Great activities to try with a group of people.

Deer Park

Deer can be seen wandering and feeding in the large fenced park, and depending on the time of year, fawns may be spotted hiding within the park. To see the deer up close, visit the deer from the viewing platform at feeding time.

Adventure Playgrounds!

There are two separate Adventure Playgrounds at Gumleaves that are full of exciting physical activities! These playgrounds include flying foxes, giant see-saws, tyre swings, cargo nets and cat-walks. Excellent Fun!



Family Day Passes

Ideal for those who want to come and enjoy the property and all of our activities, but don't want to spend the night. The Family Day Pass gives your group access to all activities, barbecue sites and toilets for the day. A Day Pass is a great way to spend the day with family and friends – they also make great gifts!

Lake Mulga

Lake Mulga is ideal for various water-based activities, such as swimming and boating. We have canoes, rowboats and life jackets available for use free of charge. There are jetties that can be used for launching the boats and jumping from.



Night Time Fun

There are plenty of possums and kangaroos to spot with a torch during a night bush walk – often the possums will even come to your accommodation! Maybe you could play a game of night time hide and seek - or maybe you'd prefer marshmallow and damper cooking around your own outdoor fire? It is also a good idea to bring along a pack of cards or some board games.

Mini Golf

A nine-hole mini golf course is located just near Reception, and clubs and balls are provided free of charge. Completion of the nine holes takes approximately half an hour.

Tennis Court

The full sized tennis court is located near Lake Mulga. Racquets and balls are available free of charge and there is no charge to hire the court!

Bushwalking

We have several, marked tracks on the property. These walks will take you all over Gumleaves' 400 acres of bushland, from a simple stroll around the lake to a more intense climb to the top of the ridge for views to Maria Island.

Air Walk and GIANT Flying Fox

A rope walkway, suspended six metres above the ground leading to a huge flying fox that swoops down over the small lake! Not for the faint hearted!

Accommodation

Self Contained Cabins

Our two and three bedroom cabins are fully self contained with all bedding supplied. Each has a fully equipped kitchen, private barbecue area and verandah. There are four sizes of cabin accommodation available, with the largest sleeping up to ten guests. All cabins except the large 3 bedroom cabin have a day/night lounge. Accommodation price includes access to all onsite activities.

Camping and Caravans

Powered and non-powered caravan sites are available, and include access to the amenities block. The camping area is located near the Lake and has its own amenities block and camper's kitchen. Both camping and caravan areas have barbecue sites and camp fires, and wood is provided.

Group Accommodation

We have two areas suitable for larger groups to use. Gum Grove Camp area can sleep up to 63 people, and The Barks Camp area can sleep up to 45. Accommodation is in dormitory style rooms. Full catering is available, or you are welcome to self cater using the commercial kitchens and large dining rooms.

Please note: Pets are not allowed on the property

Nearby Attractions

Maria Island & Freycinet National Parks

Maria Island National Park offers wildlife, convict settlement, fossil cliffs, forests and wonderful landscapes. The ferry departs from the East Coaster Resort at Orford. Picturesque Freycinet has bush walking tracks, excellent beaches and the world famous Wine Glass Bay. National park entry fees apply to both Parks.

Little Swanport River

One kilometre north of Gumleaves, the Little Swanport River boasts excellent Bream fishing.

Beaches

There are several world class beaches within 15 minutes drive of Gumleaves. But please be aware of the warning signs before you decide to enter the water.

Wielangta Rain Forest

Located approximately 40km south of Gumleaves, with the turn off at Orford, Wielangta Rainforest is well worth a visit. It is an ideal place to stop for morning tea or lunch.

Two Bedroom Cabin – Sleeps 6

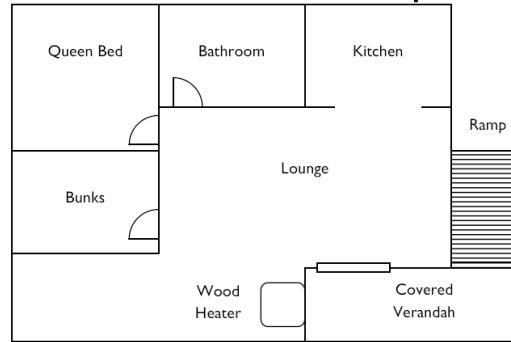

Large Two Bedroom Cabin – Sleeps 8

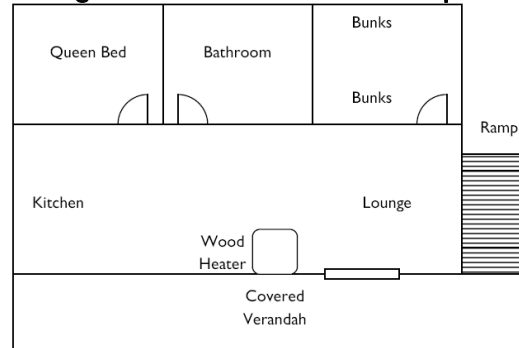

Three Bedroom Cabin – Sleeps 10

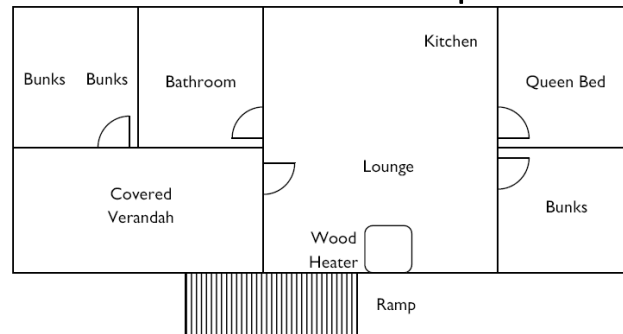

Large Three Bedroom Cabin – Sleeps 6

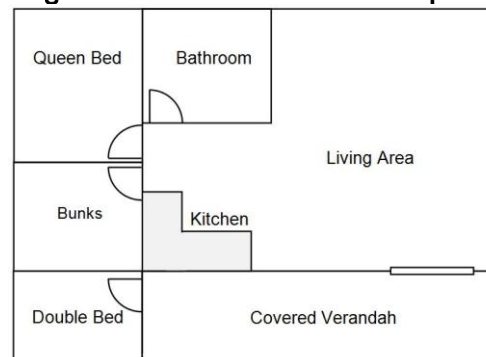

How to get to Gumleaves...

219 Swanston Road, Little Swanport, East Coast, Tasmania

- 175 kilometres south-east of Launceston
- 110 kilometres north-east of Hobart
- 19km north of Triabunna and 27km south of Swansea



Shoe Fence!

We're trying to compete with the Shoe Fences from other countries – so bring along your old shoes and add them to the fence on the Main Road. Let's try and beat the record! (Don't forget to write your name on your shoes!)



Contact Us

Ph: (03) 6244 8147 (b/h)

Email: info@gumleaves.com.au

www.gumleaves.com.au