

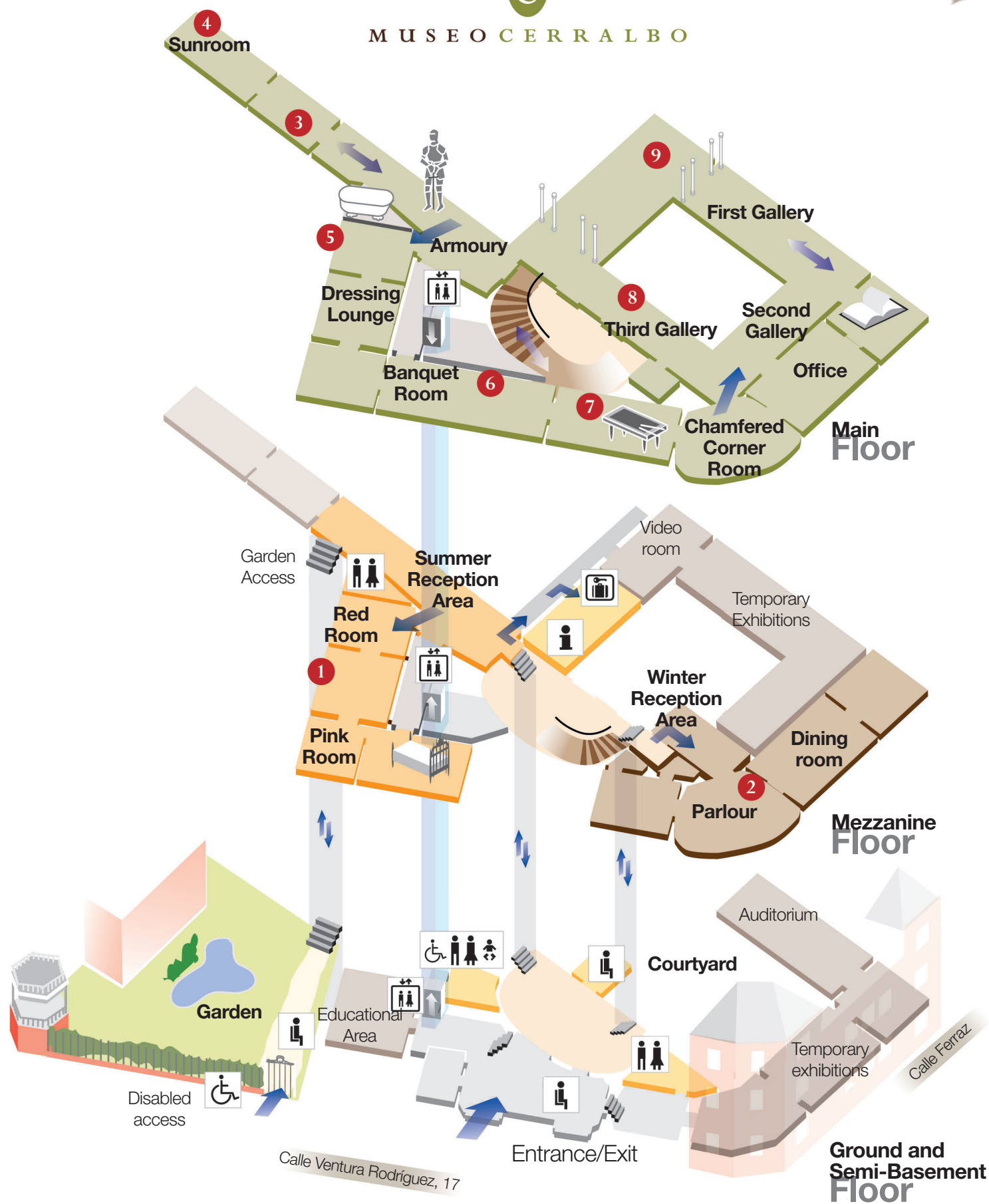

MUSEO CERRALBO



Ticket Office



Toilets



Rest area



Accessible toilet/
Baby changing facilities



Lockers



Lift



Disabled access



The Museum recommends

The Museum recommends



1 The original **wallpaper** preserved in the Yellow Room.

2 Allegories of the Four Elements of Nature decorate the Meissen **porcelain vases**.

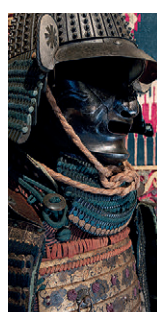

3 If you're attracted to the Orient, don't miss the **Samurai Japanese armour** in the Arab Room.

4 **Iberian falcata** from the necropolis of Las Angosturas in Granada, with striking silver decoration.



5 The **Room of Little Columns**, profusely decorated with 18th century ceramic busts, votive offerings and idols from Antiquity.

6 Two bunches of white grapes of the 17th century set the Dining Room next to the flowers and **still life** pictures.



7 The **Billiard Room** is dominated by a French billiard table surrounded by high couches with footrests.

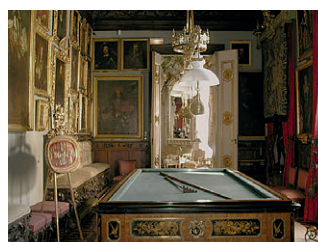

8 One of the best versions of *Saint Francis in Ecstasy* by **El Greco**.



9 The **Ballroom**, where time seems to stand still, epitomises the charm of this Madrilenian mansion.

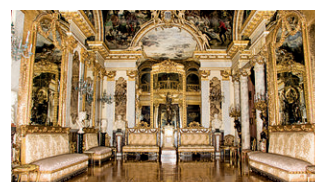

More Museum

What's on today

Discover our cultural and educational activities at the ticket office, on the museum's website at en.museocerralbo.mcu.es or on social networks.



Instagram



Accessible
Museum code

Support the Museum

Through the Cerralbo Museum Foundation and en.museocerralbo.mcu.es/colabora/colabora.html.

Rest Areas

In the Garden, in the Entrance Hall and in the designated area on the Ground Floor.

Opening times

From Tuesday to Saturday, 9.30 a.m. to 3.00 p.m.

Thursday afternoon (except public holidays), from 5.00 p.m. to 8.00 p.m.

Closed on Mondays, and 1 and 6 January, 1 May, 24, 25 and 31 December and local public holiday.

Maximum capacity limited to 60 people simultaneously for conservation reasons.

Free days: Thursday afternoons; Saturdays after 2.00 p.m. and all day Sunday.

Services

- Guidebooks to the rooms (in various languages)
- Audio guide (in various languages)
- Guided visits
- Accessible itinerary
- Wheelchair
- Hearing loops

More time to visit

If you have enjoyed this museum, come back and learn something new. You can visit other similar Museums in the centre of Madrid that are easy to reach from the Museo Cerralbo, either on foot, by bike or by public transport.

Museo Lázaro Galdiano

Calle Serrano, 122
Metro, línea 10: Ruben Darío



Museo Nacional de Artes Decorativas

Calle Montalbán, 12
Metro, línea 2: Banco de España

Museo del Romanticismo

Calle San Mateo, 13
Metro, línea 10: Alonso Martínez or Tribunal

Museo Sorolla

Paseo General Martínez Campos, 37
Metro, línea 10: Gregorio Marañón

Museo Cerralbo

Calle Ventura Rodríguez, 17. 28008 Madrid
Tel. 34-915 47 36 46 / 47
museo.cerralbo@mecd.es



Published by © Ministry of Education, Culture and Sports.
General Technical Secretariat. S.G. of Documentation and Publications.
Design and digital graphics: Marcos Balfagón Sierra.
NIPO: 030-14-005-8. Legal Deposit: M-6468-2014.
Printed by: Punto Verde, S.A. on recycled paper.